

MOVIE PROJECTION SYSTEM

It is your responsibility to test this unit prior to its scheduled use and be familiar with its operation. All questions or concerns must be addressed at that time by calling our store during store hours. NO CREDIT will be given after this point.

This unit is designed for HDMI video and 1/8" TRS Headphone "style" audio input only into the projection console. **DO NOT** use any other type of input into the video projection console OR do not plug anything directly into the speakers other than the cords provided.

Each unit is thoroughly tested before each rental for proper functionality of all components. No credit given for problems that may arise with the use of other input devices.

All system components and packing must be kept clean and dry. Repack as received and store in a weather protected place after use. DO NOT leave any components outdoors overnight. Weather or dew can damage Electronics and Screens.

Renter accepts responsibility for any and all damages to the unit. Individual component replacement cost available upon request and can be as much as \$1200 each.

What The System Includes...

MOVIE SYSTEM ONLY



1 - Projection Console



2 - 250W Speakers



2 - 50' XLR /Power Cords
(Black/Brown)

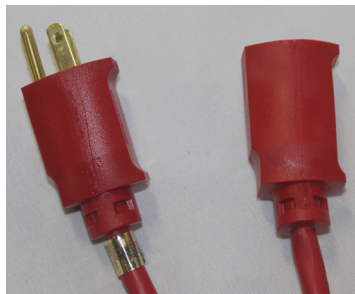

1 - 100' Power Cord (Red)

WITH INFLATABLE SCREEN



1 - 16' Wide Inflatable Screen with Straps



2 - Speaker Stands
1 - Carry Bag



1 - Air Blower with Muffler Surround



4 - Twist Stakes

Additional 3 Page Instruction Sheet

I have received a 4 page instruction manual, all of the above listed items,
and understand the proper usage of this unit. _____

MOVIE PROJECTION SYSTEM

It is your responsibility to test this unit prior to its scheduled use and be familiar with its operation. All questions or concerns must be addressed at that time by calling our store during store hours. NO CREDIT will be given after this point.

This unit is designed for HDMI video and 1/8" TRS Headphone "style" audio input only into the projection console. **DO NOT** use any other type of input into the video projection console OR do not plug anything directly into the speakers other than the cords provided.

Each unit is thoroughly tested before each rental for proper functionality of all components. No credit given for problems that may arise with the use of other input devices.

All system components and packing must be kept clean and dry. Repack as received and store in a weather protected place after use. DO NOT leave any components outdoors overnight. Weather or dew can damage Electronics and Screens.

Renter accepts responsibility for any and all damages to the unit. Individual component replacement cost available upon request and can be as much as \$1200 each.

What The System Includes...

MOVIE SYSTEM ONLY



1 - Projection Console



2 - 250W Speakers



2 - 50' XLR /Power Cords
(Black/Brown)



1 - 100' Power Cord (Red)

WITH INFLATABLE SCREEN



1 - 16' Wide Inflatable Screen with Straps



2 - Speaker Stands
1 - Carry Bag



1 - Air Blower with Muffler Surround



4 - Twist Stakes

Additional 3 Page Instruction Sheet

I have received a 4 page instruction manual, all of the above listed items,
and understand the proper usage of this unit. _____

MOVIE SYSTEM SETUP

STEP 1: SETUP SPEAKER STANDS

Remove speaker stands from protective bags and pace about five feet to each side of the Screen. Extend the speaker stand legs so that the leg supports are parallel to the ground. Raise pedestal on speaker stand to desired height, about 5 to 6 feet.

ATTENTION: Do not over tighten the locking knob. The pin supports the weight of the speaker, not the locking knob on the stand.

STEP 2: PLACE SPEAKERS

Place speaker stands in line with the screen - about 4 feet away from each side.

STEP 3: PROJECTION CONSOLE PLACEMENT

Center the projection console on the ground in front of the screen (at approximately 24 feet with our inflatable screen) with the faceplate and latches towards the screen. The projector's zoom function will allow for image size adjustment after the projector has been placed.

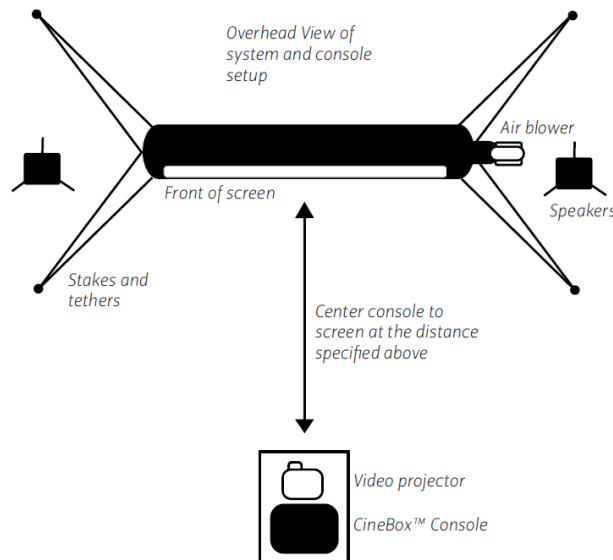

STEP 4: OPEN PROJECTION CONSOLE

Carefully take off the front plate and top cover completely off of the console.

Do not plug projection console in until after this step is completed and all lines are connected.

STEP 5: CONNECT CORDS

Connect the XLR/Power Cords (black/brown twin cable) to each speaker then to the screen left and screen right XLR/power outlets on the projection console. Then plug the main projection console power cord, the white sord, coming out of the rear of the box, to your power source with the provided RED 100' cord.

DO NOT plug in any additional items to these cords. They are designed for the power use of this unit and its components **ONLY**.

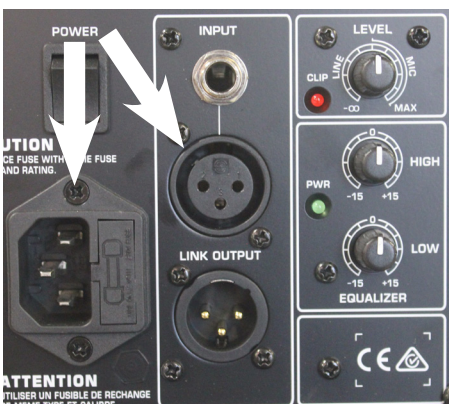

STEP 6: POWER ON MEDIA PLAYER

Power on the Blu-Ray/DVD Player. The audio mixer should power on automatically when the main power is plugged in.

ATTENTION: The audio mixer power light will illuminate when powered on. It is possible for an audio signal to pass through the mixer when it is off, but the signal will be very weak. Make certain that the audio mixer is powered on for proper audio levels.



STEP 7: POWER ON SPEAKERS AND AUDIO VOLUME

Return to speakers and turn them on. Next, slowly increase the speaker level (volume) to 50% so the line on the volume knob is pointing directly up. Volume adjustment should be done through the audio mixer on the projection console.

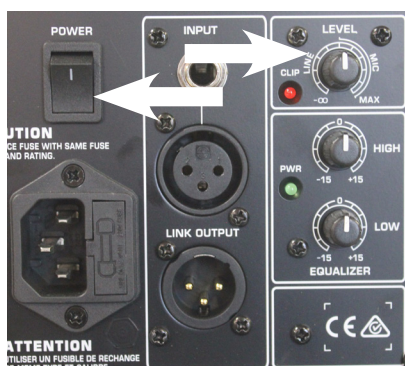

STEP 8: PERFORM SOUND CHECK

Slowly increase the volume knob labeled "Level 1" until the volume from the speakers reaches the desired level for either the Blue Ray/DVD player or for another HDMI input device.

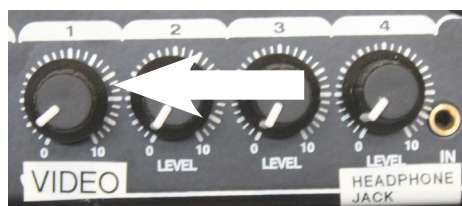

SYSTEM TAKEDOWN

You must power down the projector by pushing the power button on top of the projector twice (once for the power down menu the second time to confirm power down).



Make sure the projector cools down completely (light turns from blue to red) before unplugging or turning off the power source. Failure to do so could result in projector or bulb damage.

Turn down all audio and other knobs on mixers and speakers. Power down all electronic components and neatly coil all cables and return them to projection console storage compartment. Take down speaker stands and return to speaker stand case.

CONNECTING OTHER DEVICES

CONNECTING COMPUTERS or VIDEO GAME SYSTEMS

Any unit you are trying to use with this system must be HDMI compatible.

Connect the "monitor or video out" of the laptop or game system to the HDMI 2 plug on the input panel of the projection console. Change the input on the projector to HDMI 2. See changing projector input for instructions.



CONNECTING IPODS and MP3 PLAYERS

To play sound or music from an auxiliary device such as an iPod, Laptop or other MP3 player, plug the 1/8" jack from the front of the input panel of the projection console into any standard headphone jack. Use Audio 4 Volume Control.



CHANGING PROJECTOR INPUT

To change projector input between HDMI 1 (Blue Ray/DVD Player) and HDMI 2 (AUX Input) press the ◀ key on the top of the projector to enter the source select menu. Once the menu is up, use the ▲ or ▼ keys to highlight your desired input. Then press the ↵ (enter) key to choose selection.



TROUBLESHOOTING

NO SOUND

Starting at the audio source, make sure:

- 1) All components are connected to the correct audio input and output.
- 2) The audio source, audio mixer and speakers are properly plugged in and turned on
- 3) The volume is turned up on the audio source, audio mixer and speakers.

NO IMAGE

Starting at the image source, make sure all components are connected to the correct input and output. Make sure the correct projector input is selected. Make sure the image source and projector are turned on.

**If you have any problems, please call immediately so we can help walk you through setup issues.
(860) 496-RENT (7368)**